

Kawasaki *i* SOUNDZ Music™

Thank you for purchasing the Kawasaki i soundz Audio Pro Digital Drum. This interactive drum will bring you hours of fun for the entire family.

Audio Pro Digital Drum

IMPORTANT

PLAY SWITCH

This switch is on the back of the digital drum. The digital drum is shipped in TRY ME mode for the Try Me function on the store shelf. When you get your digital drum home please turn the switch to the PLAY mode.

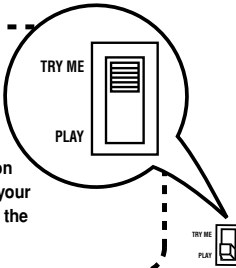

MP3 MUSIC PLAYER HOLDER

You can play your drum with or without your MP3 player. If you choose to use your MP3 player, the MP3 music player holder provides a space for you to put your MP3 music player. If you choose not to use your MP3 player, there is some very cool music already programmed!

The holder fits some MP3 players but not all of them. If yours does not fit, you can plug the jack in and lay it on the surface you're playing on. After you plug in your MP3 player, turn it on and adjust the volume to the desired level.

DRUM PAD

There are 6 drum pads to drum on. Use the drum sticks to hit the drum pads and play some great music.

DRUM STICK HOLDER

Use these 2 holders to store your drum sticks after you are done playing the drum.

WORKS WITH



DRUM STICKS
Use these great drum sticks to drum away.

10 INSTRUMENTS
There are 10 different instruments to choose from. Press the top or bottom to hear and play the 10 instruments.

10 RHYTHMS
There are 10 rhythms to play along with. Press the 10 buttons to hear all of them.

DRUM PAD
There are 6 drum pads to drum on. Use the drum sticks to hit the drum pads and play some great music.

ON/OFF SWITCH

The on/off switch works the digital drum. Press the switch to ON and you can play your digital drum. Turn the switch off after you are finished playing with the digital drum.

VOLUME CONTROL
Press either side to raise or lower the volume to your desired level.

TEMPO CONTROL
Press either side to speed up or slow down the tempo of the music you are playing.

HIGH QUALITY SPEAKER

HEADPHONE JACK
Plug your headphone into this jack for private listening. Most headphones can be used. A headphone is not included.

SING ALONG JACK
You can sing along with your favorite musicians or the music you are playing. Just plug in a sing along mic into this jack and sing along. Kawasaki i soundz music also has an audio pro mic available for separate purchase.

DRUM STICK HOLDER
Use these 2 holders to store your drum sticks after you are done playing the drum.

AUTO OFF OR SLEEP MODE
The drum will turn off automatically (sleep mode) after 30 seconds of non use. To activate the drum pads you have to first press the buttons and then play the drum sounds on the drum pads.

THIS DEVICE COMPLIES WITH PART 15 OF THE FCC RULES. OPERATION IS SUBJECT TO THE FOLLOWING TWO CONDITIONS: (1) THIS DEVICE MAY NOT CAUSE HARMFUL INTERFERENCE, AND (2) THIS DEVICE MUST ACCEPT ANY INTERFERENCE RECEIVED, INCLUDING INTERFERENCE THAT MAY CAUSE UNDESIRABLE OPERATION. NOTE: THE MANUFACTURER IS NOT RESPONSIBLE FOR ANY RADIO OR TV INTERFERENCE CAUSED BY UNAUTHORIZED MODIFICATIONS TO THE EQUIPMENT SUCH MODIFICATIONS COULD VOID THE USER AUTHORITY TO OPERATE THE EQUIPMENT. PURSUANT TO PART 15 OF THE FCC RULES, THESE LIMITS ARE DESIGNED TO PROVIDE REASONABLE PROTECTION AGAINST HARMFUL INTERFERENCE IN A RESIDENTIAL INSTALLATION. THIS EQUIPMENT GENERATES, USES AND CAN RADIATE RADIO FREQUENCY ENERGY AND IF NOT INSTALLED AND USED IN ACCORDANCE WITH THE INSTRUCTIONS, MAY CAUSE HARMFUL INTERFERENCE TO RADIO COMMUNICATIONS. HOWEVER, THERE IS NO GUARANTEE THAT INTERFERENCE WILL NOT OCCUR IN A PARTICULAR INSTALLATION. IF THIS EQUIPMENT DOES CAUSE HARMFUL INTERFERENCE TO RADIO OR TELEVISION RECEPTION, WHICH CAN BE DETERMINED BY TURNING THE EQUIPMENT OFF AND ON, THE USER IS ENCOURAGED TO TRY TO CORRECT THE INTERFERENCE BY ONE OR MORE OF THE FOLLOWING MEASURES:

- REORIENT OR RELOCATE THE RECEIVING ANTENNA.
- INCREASE THE SEPARATION BETWEEN THE EQUIPMENT AND RECEIVER.
- CONNECT THE EQUIPMENT INTO AN OUTLET ON A CIRCUIT DIFFERENT FROM THAT TO WHICH THE RECEIVER IS CONNECTED.
- CONSULT THE DEALER OR AN EXPERIENCE RADIO/TV TECHNICIAN FOR HELP.

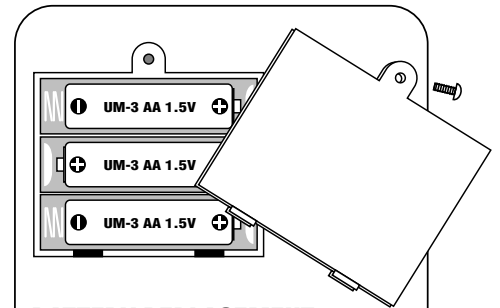

BATTERY REPLACEMENT

REMOVE SCREW TO OPEN BATTERY COMPARTMENT COVER. THIS UNIT REQUIRES 3 "UM-3" "AA" BATTERIES (INCLUDED). ALWAYS REPLACE ALL THREE BATTERIES AT THE SAME TIME. REPLACE BATTERY COMPARTMENT COVER AND SCREW. ALKALINE BATTERIES ARE RECOMMENDED FOR BEST PERFORMANCE. DO NOT MIX OLD AND NEW BATTERIES. DO NOT MIX ALKALINE, STANDARD (CARBON-ZINC), OR RECHARGEABLE (NICKEL-CADMIUM) BATTERIES. NON-RECHARGEABLE BATTERIES ARE NOT TO BE RECHARGED. BATTERIES ARE TO BE INSERTED WITH THE CORRECT POLARITY. EXHAUSTED BATTERIES ARE TO BE REMOVED FROM THE TOY. THE SUPPLY TERMINALS ARE NOT TO BE SHORT-CIRCUITED. RECHARGEABLE BATTERIES ARE TO BE REMOVED FROM THE TOY BEFORE BEING CHARGED. RECHARGEABLE BATTERIES ARE ONLY TO BE CHARGED UNDER ADULT SUPERVISION. ONLY BATTERIES OF THE SAME OR EQUIVALENT TYPE AS RECOMMENDED ARE TO BE USED. DO NOT DISPOSE OF BATTERIES IN FIRE, BATTERIES MAY EXPLODE OR LEAK.

BIG MUSIC COMPANY SUBSIDIARY OF KIDZ TOYZ, INC.



because kidz like toyz
KIDZ TOYZ, INC. MT. KISCO, N.Y. 10549

For Product Questions,
Call 1-877-KIDZTOYZ (877-543-9869)
Ask for CUSTOMER SERVICE.
Only in the U.S. and CANADA



87-11504-45628

KAWASAKI® IS A TRADEMARK LICENSED BY KAWASAKI MOTORS CORP., U.S.A., WHICH DOES NOT MANUFACTURE OR DISTRIBUTE THIS PRODUCT. CONSUMER INQUIRIES SHOULD BE DIRECTED TO KIDZ TOYZ, INC., 280 NORTH BEDFORD ROAD, SUITE 203, MT. KISCO, NEW YORK 10549 USA

iPod® is a registered trademark of Apple Computer, Inc. The product sold in this package has not been endorsed or approved by Apple Computer, Inc.

Zune® is a registered trademark of Microsoft Corporation.

Please visit us on the web at www.kidztoyz.com

MADE IN CHINA
ITEM NO. 77212